

# CORNER RECORD

Document Number A.P.# 028-111-12

City of MILL VALLEY

County of MARIN, California

Brief Legal Description A PORTION OF LOT 46, RACK 1 PULL 2, 32 O.S. 34

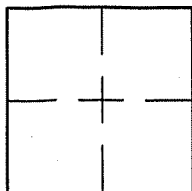

## CORNER TYPE

## COORDINATES (Optional)

Government Corner ☐ Control ☐  
 Meander ☐ Property ☒  
 Rancho ☐ Other ☐

Date of Survey 2/16/06

N. \_\_\_\_\_  
 E. \_\_\_\_\_  
 Zone \_\_\_\_\_ NAD27 ☐ NAD83 ☐  
 NAD83 Epoch \_\_\_\_\_  
 Elev. \_\_\_\_\_  
 Vert. Datum: NGVD29 ☐ NAVD88 ☐  
 Meas. Units: Metric ☐ Imperial ☐

Corner- Left as found ☒ Found and tagged ☐ Established ☒ Reestablished ☐ Rebuilt ☐

Identification and type of corner found: Evidence used to identify or procedure used to establish or reestablish the corner:

FOUND REBAR AND CAP L.S. 3971 PER 32 O.S. 34 AND SET CORNERS SEE SHEET 2

A description of the physical condition of the monument as found and as set or reset: SEE SHEET 2.

## SURVEYOR'S STATEMENT

This Corner Record was prepared by me or under my direction in conformance with

the Land Surveyor's Act on FEBRUARY 16 2006

Signed Lawrence P. Doyle P.L.S. or R.C.E. No. P.L.S. 4694

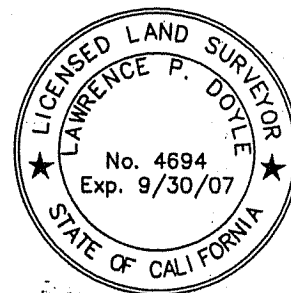

## COUNTY SURVEYOR'S STATEMENT

This Corner Record was received FEBRUARY 27, 2006

and examined and filed MARCH 22, 2006

Signed [Signature] P.L.S. or R.C.E. No. 7128

Title COUNTY SURVEYOR

County Surveyor's Comment \_\_\_\_\_

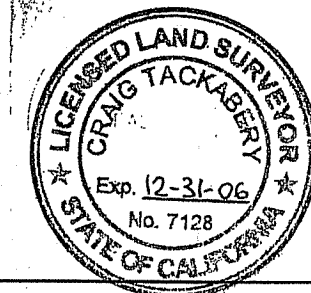

RACK 1 PULL 2  
LOT 46

WILDOMAR STREET

LANDS OF STONE  
D.N. 99-026709  
32 O.S. 34

MOLINO AVENUE

LOT 45

BASIS OF BEARING

THE BASIS OF BEARING FOR THIS SURVEY  
IS BETWEEN FOUND PIPES PER 32 O.S. 34

LEGEND

- FOUND PIPE & PLUG L.S. 3971, PER 32 O.S. 34
- FOUND REBAR & CAP L.S. 3971, PER 32 O.S. 34
- SET PIPE & PLUG L.S. 4694
- ⊕ SET NAIL & TAG L.S. 4694

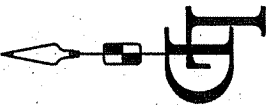

**CORNER RECORD**  
**A PORTION OF LOT 46 / 32 O.S. 34**

MARIN COUNTY CALIFORNIA

SCALE: 1" = 30'	DRAWN BY:
DATE: 2/16/06	SHEET 2 OF 2
LAWRENCE P. DOYLE LAND SURVEYOR/CIVIL ENGINEER P.O. BOX 1609 MILL VALLEY CA 94642 (415-388-9585)	

DRAWING NO.  
1445-05

